

WorkLife OFFICE SUITES

by **INDUSTRIOUS**

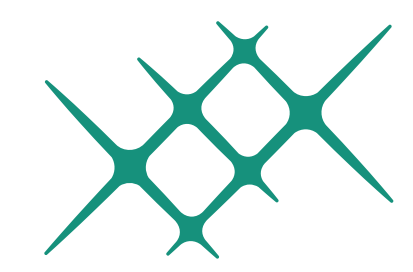

Great Days Start Here.



Thoroughly Professional and Thoughtfully Designed

For the businesses that put their employees first,
great days start at WorkLife Office Suites.



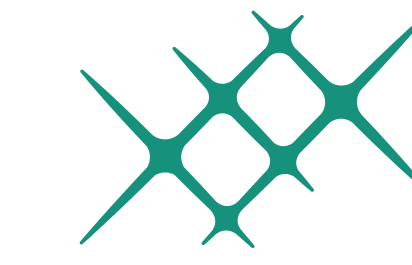

Full-Service Memberships

At WorkLife Office Suites, our workplaces are so much more than spaces. They're full-service memberships with everything teams need to keep their businesses running, without breaking to make another cup of coffee or having to pay extra for color printing.

And because we believe bringing people together helps businesses grow, we host happy hours and professional development events in our spaces.

Also included:

- Dedicated On-Site Staff
- Mail and Package Handling
- Unlimited Color Printing
- Office Supplies
- Professional-Grade Cleaning



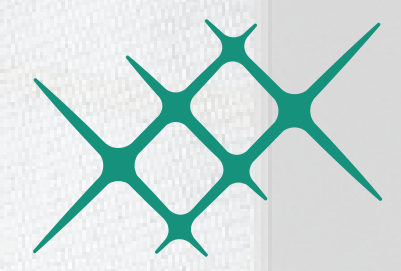

A Workplace That Evolves With You

WorkLife Office Suites can accommodate the single freelancer to an expanding startup with 50+ employees. We provide the tools that help modern companies reposition their portfolios to meet the demand of a changing workplace.



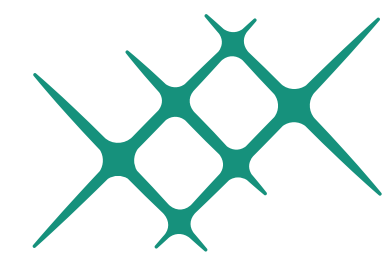

Workplace products designed to support the unique needs of your team

Our workplace solutions bring together the ideal spaces, technology and membership options to solve your unique real-estate challenges.

We give you the platform you need to provide your teams with the ideal combination of unlimited or use-based access, to dedicated or shared workplaces across our national network of locations.

MEMBERSHIP TYPES:

- CANVAS** Customized office space for teams of 20+
- SUITES** Turn-key office space for teams of 7-20
- OFFICES** Turn-key office space for teams of 1-6

COMMON SPACES:

- COMMON ROOMS** Conference rooms, phone booths, mother's rooms
- LOUNGES** Common lounges, pantries, and hangout areas
- LANDSCAPED TERRACE** Common terrace furnished with work tables and lounge areas

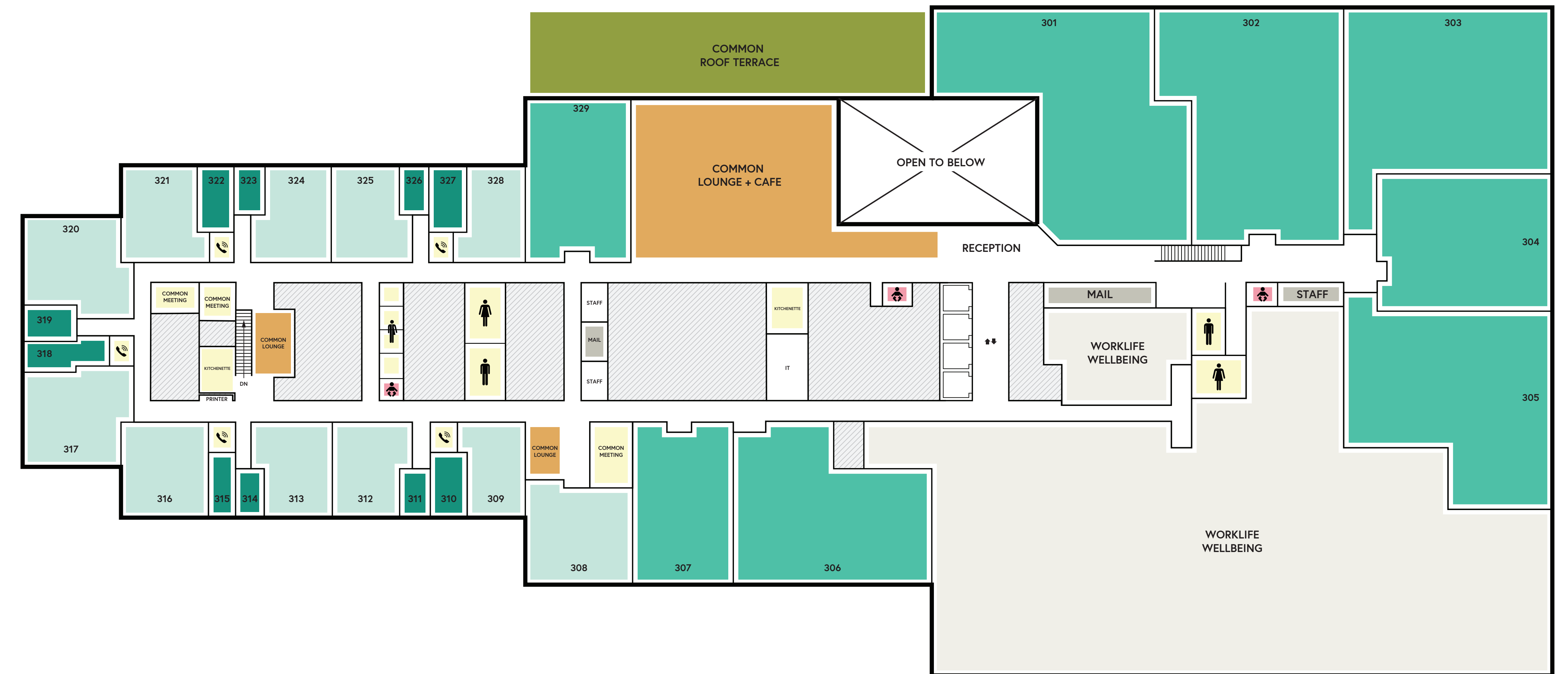

Third Floor

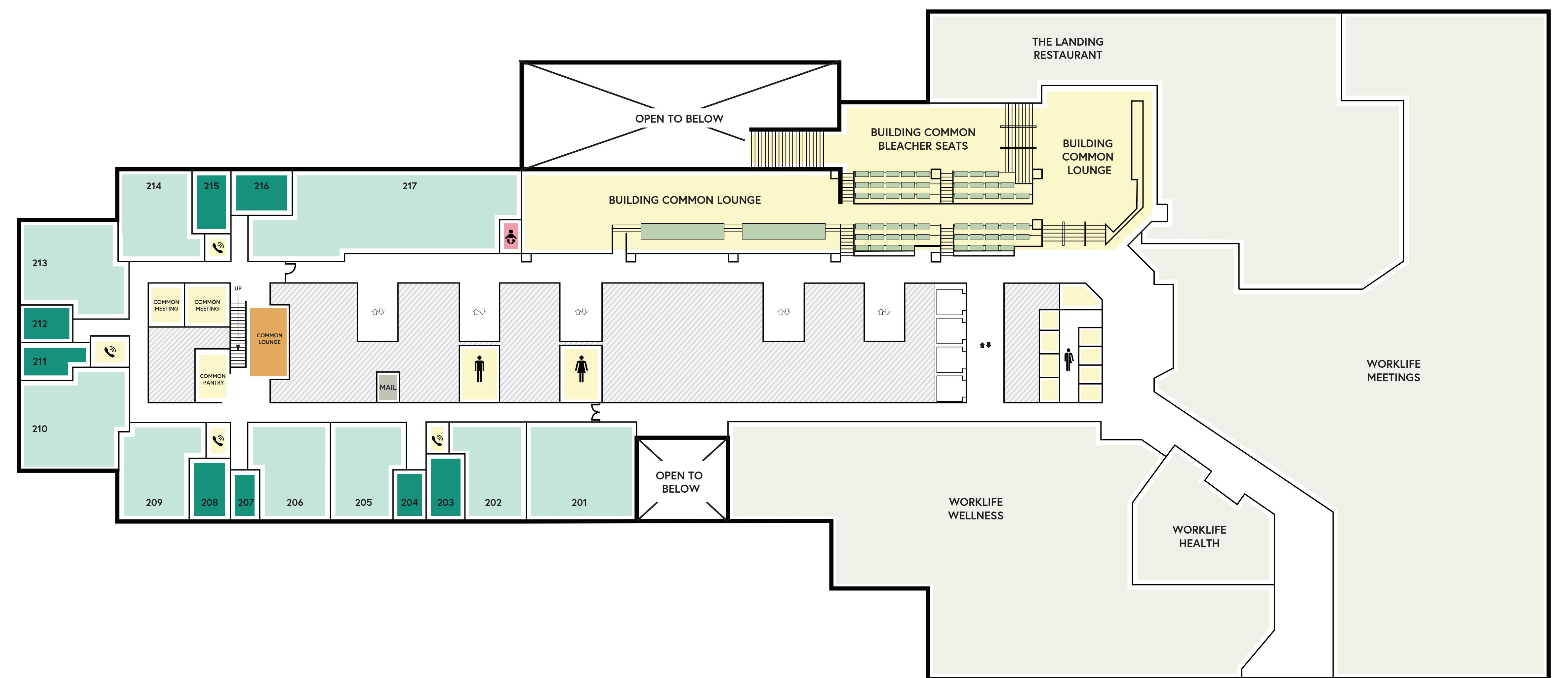

Second Floor



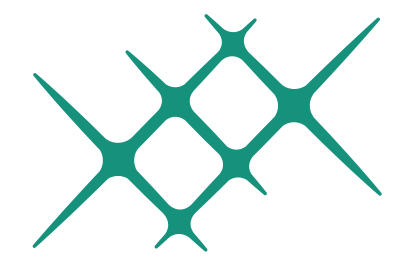

Second Floor

- SUITES
- OFFICES
- COMMON ROOMS



WorkLife OFFICE SUITES

by **INDUSTRIOUS**



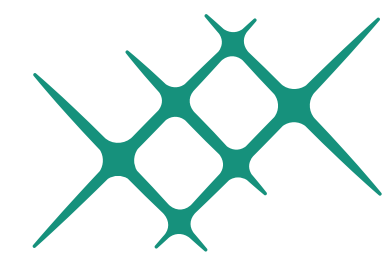

Third Floor

34TH STREET

- CANVAS
- SUITES
- OFFICES
- COMMON ROOMS



33RD STREET

WorkLife OFFICE SUITES

by **INDUSTRIOUS**





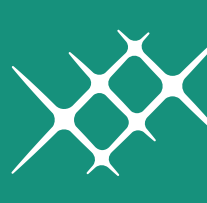







Typical Large Suite



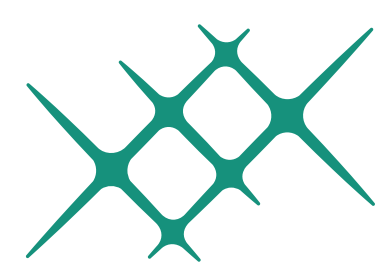

Offices

Individuals and teams can move into an office with everything they need to do their best work. Offices are designed to accommodate teams up to seven people and workstations come equipped with a task chair, sitting/standing desk and a locked storage cabinet.

Move-In Ready

Offices are fully-furnished

Shared Spaces

Members can use common areas including kitchens, conference rooms, wellness rooms, phone booths, and lounges.

24/7 Access

Need to come in on a Saturday or forgot something at work?
No problem.

TYPICAL OFFICE FLOOR PLAN

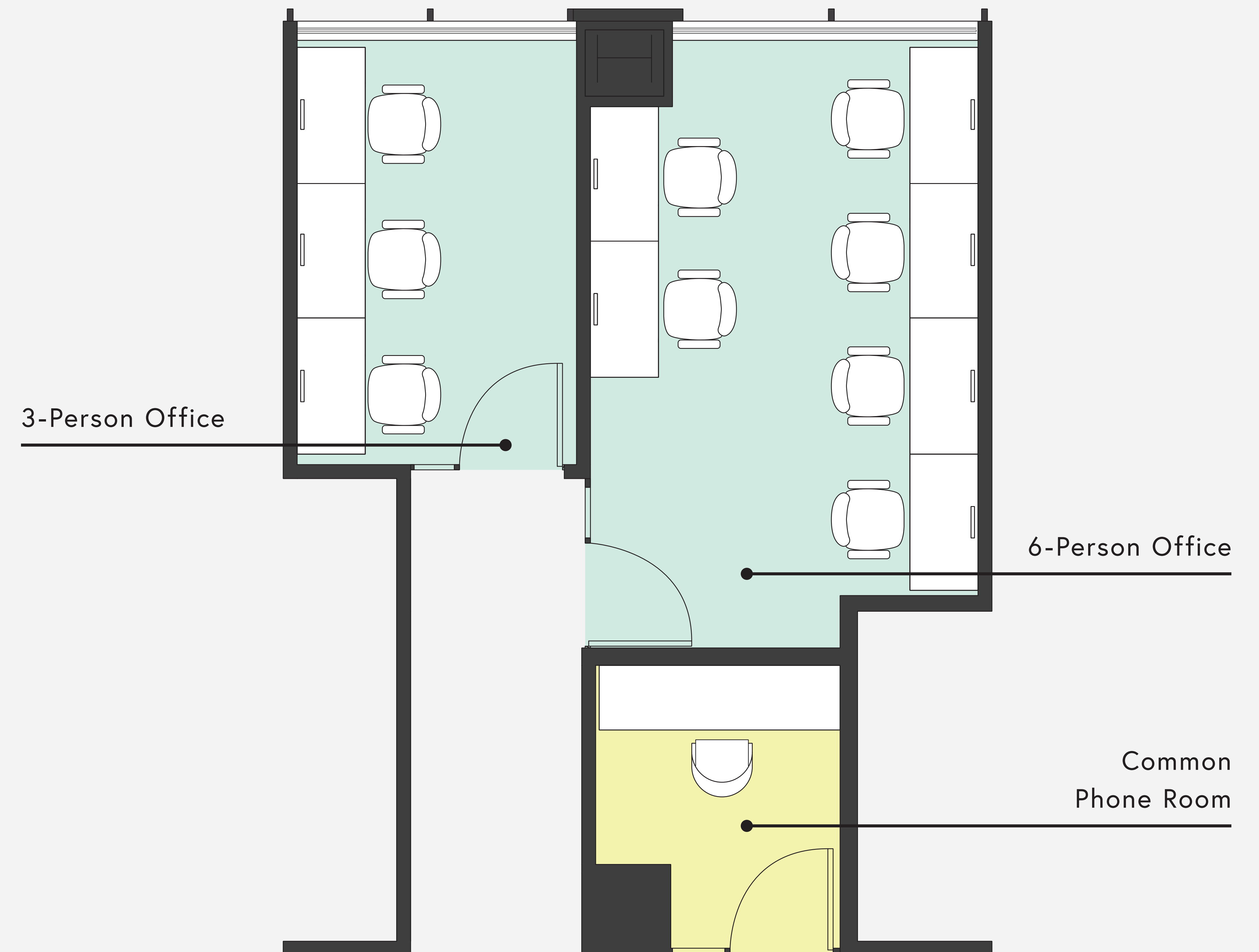

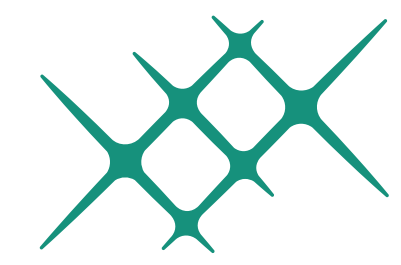

Suites

Teams up to 20 people can move into a Suite with everything they need to do their best work. Suites come with additional spaces such as private conference rooms or executive offices and include access to common areas. Each workstation comes equipped with a task chair, sitting/standing desk and a locked storage cabinet.

Move-In Ready

Suites are fully-furnished

Shared Spaces

Members can use common areas including kitchens, conference rooms, wellness rooms, phone booths, and lounges.

24/7 Access

Need to come in on a Saturday or forgot something at work? No problem.



TYPICAL SMALL SUITE FLOOR PLAN

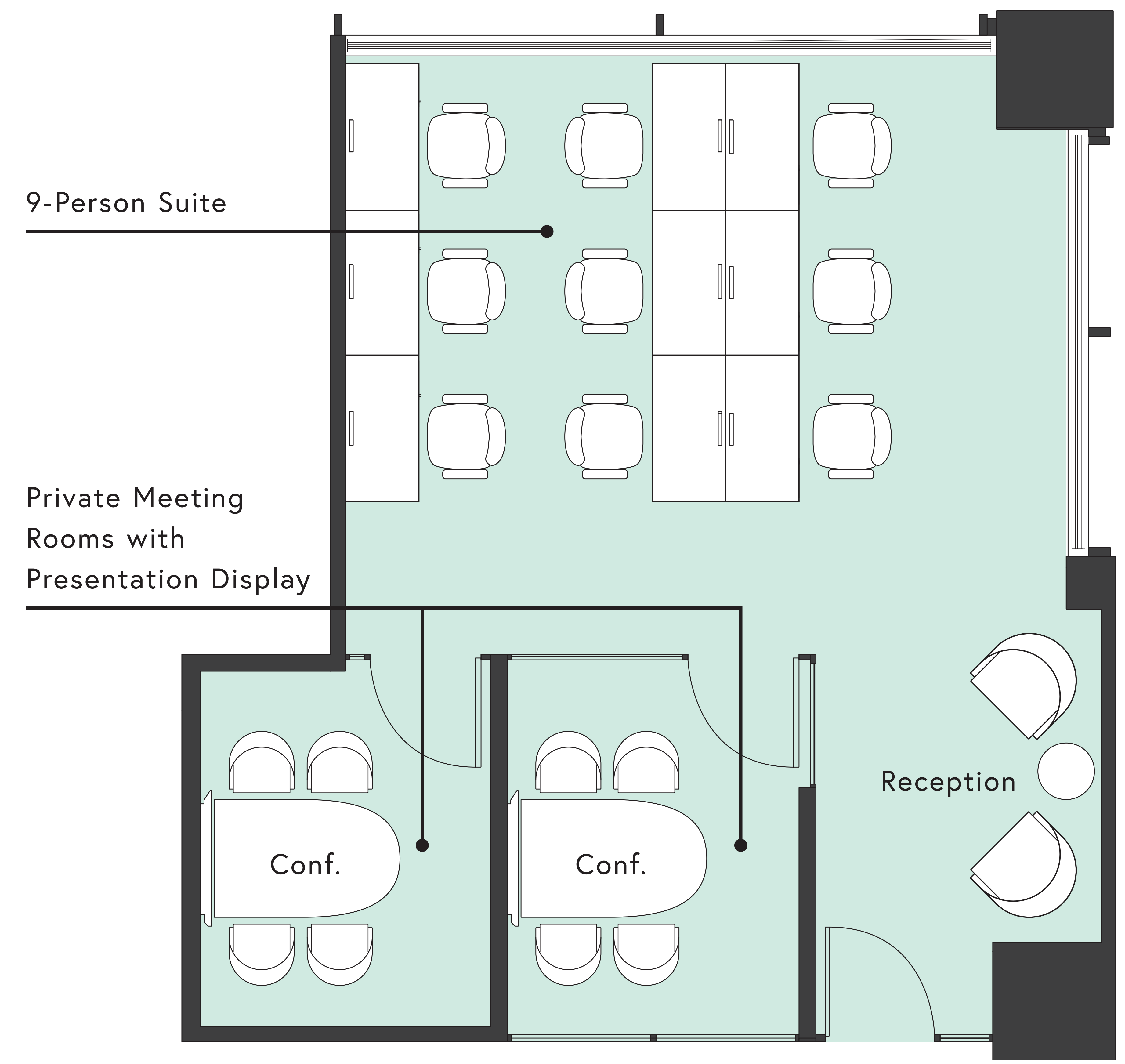

TYPICAL LARGE SUITE FLOOR PLAN

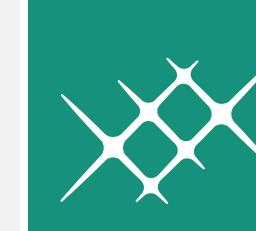
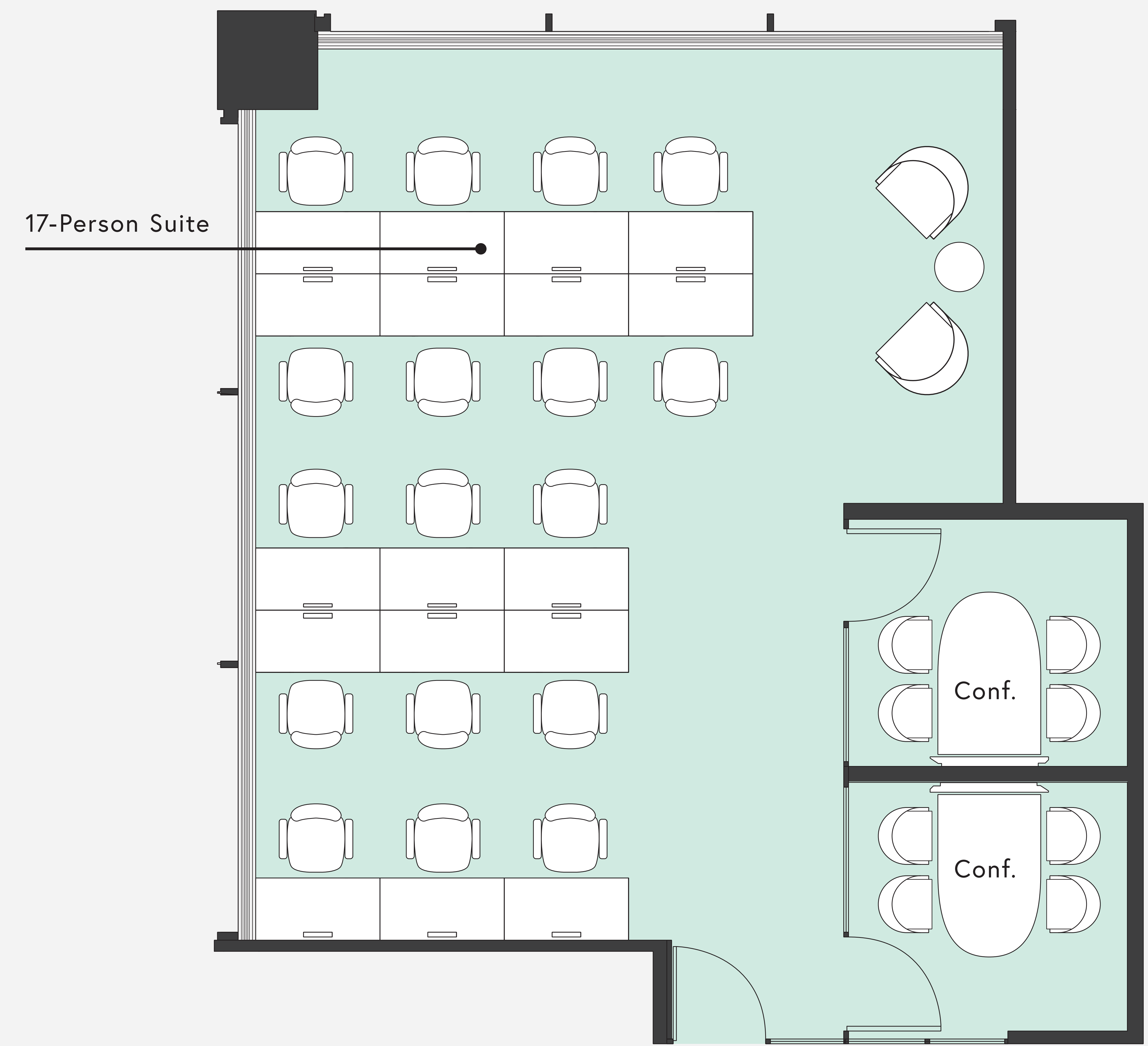

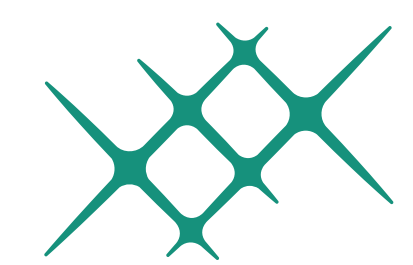

Canvas

Canvas is large office offering that is customized to your business. A turn-key opportunity designed for companies of 20-100+ people that come equipped with private meeting rooms, printing and storage areas and private pantries.

Turnkey Options

Choose a move-in ready suite designed to boost your team's productivity and performance.

Bespoke Branding

Create a workplace that reflects your company's values, identity, and aesthetic.

Behind the Scenes

We keep the office running smoothly so your team can stay laser-focused.

TYPICAL CANVAS FLOOR PLAN

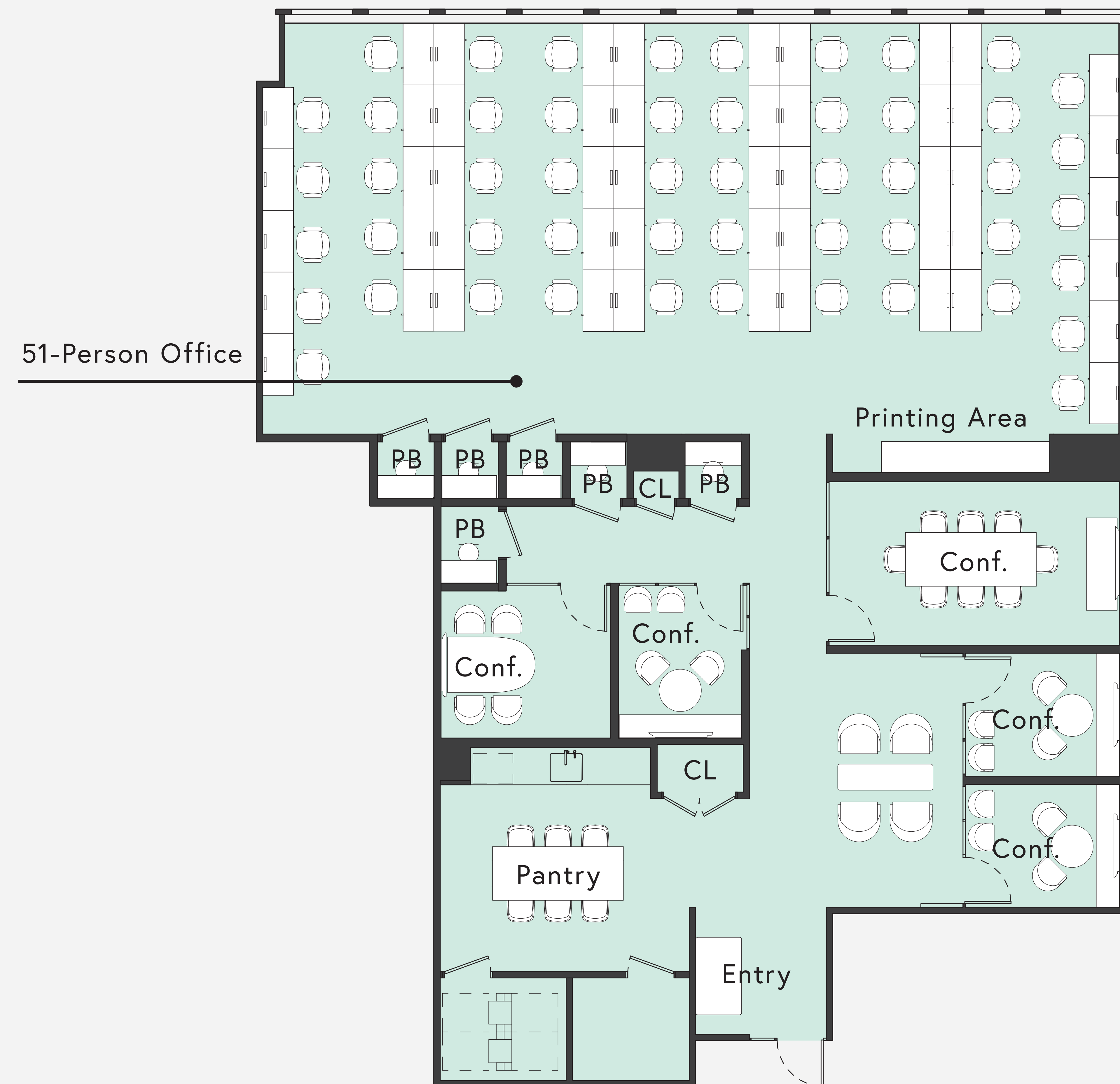

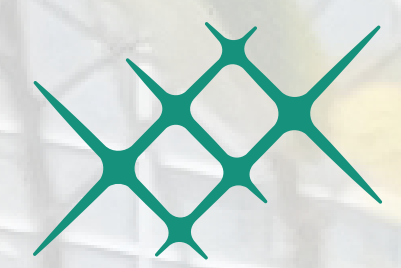

Environmental Design

At WorkLife Office Suites, we see how people inspire each other every day at work; how smart design can help shape success; and how a community can change a business for the better.

That's why our spaces and the experiences they create are at the heart of what we do. When WorkLife Office Suite members meet a new business partner in the lounge or get inspired during a team huddle, it's not by accident — it's by design.

Also Included:

- Natural Light
- Low-Density Layouts
- Wellness Rooms
- Huddle Rooms



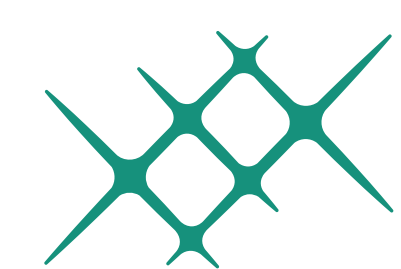

Hospitality You Can Count On

Peek into a day at WorkLife Office Suites to get a sense of the friendly and helpful service you can expect from our highly trained, experienced management team.

Arrival

Members receive a health check-in and warm welcome from our on-site staff upon arrival.

Guest Reception

When guests arrive, our on-site staff assists with visitor registration and escorts them to their destination.

Surprise & Delight

Our on-site staff looks for personal ways to make members' experience extra special, like popping a bottle of champagne to celebrate a team milestone or sharing a favorite treat just because.

Food & Beverage

Members and guests enjoy daily breakfast and snacks, a fully-stocked cafe, and surprise and delights in the afternoon.

Office Conveniences

Members have access to a mail room, unlimited color printing, and office supplies.

Meeting Set Up

Industrious offers A/V equipped conference rooms, tech support, and complimentary guest Wi-Fi — everything you need for an effective meeting.

Events & Programming

Networking, professional development events, social gatherings, and weekly happy hours further enhance the member experience.



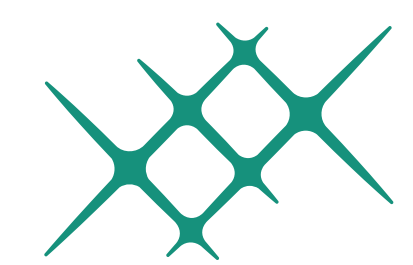

Technical Solutions

We know that your business doesn't live in one place. It goes where you go — whether you're meeting a client across town or with coworkers across a continent.

Our technical solutions seamlessly connect colleagues and campuses so that your business can work from anywhere, just like you do.

Features

- Dedicated VLANs and Servers
- A/V Equipment
- Online Member Portal
- Complimentary Guest Wi-Fi
- Static Public IP Addresses
- Secondary Internet Connection (Most Locations)
- Desktop Phones and Voicemail Services
- Softphone Application

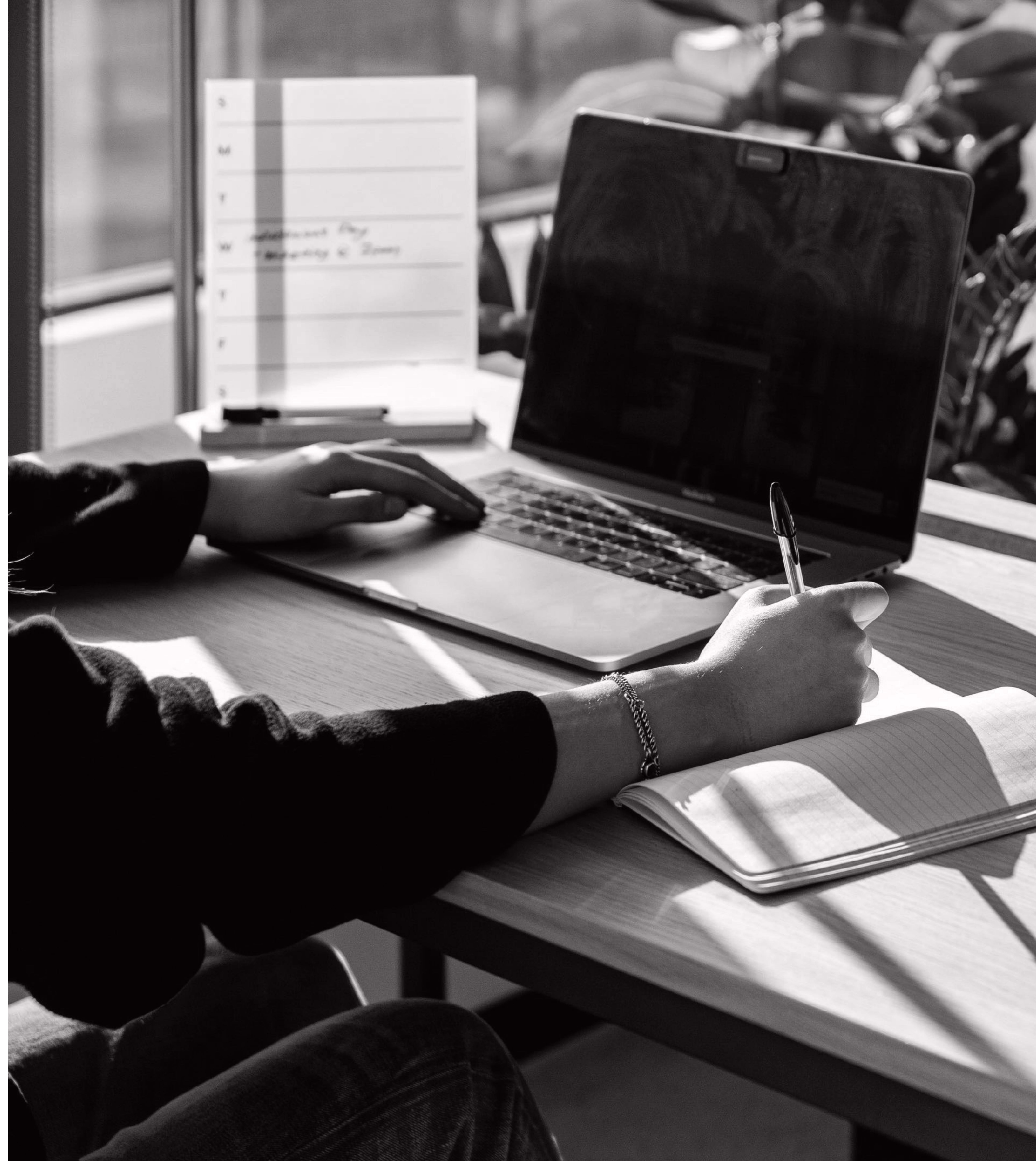

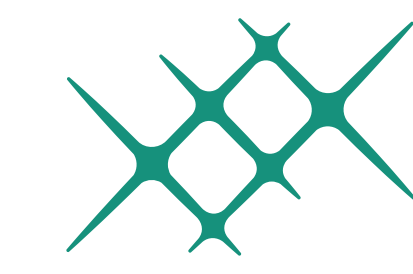

Privacy and Security

Your ideas are your business — the creativity, innovation, and knowledge that makes what you do unlike any other company out there.

We make sure that your work stays protected by keeping our locations staffed, our Wi-Fi secure, and your offices under digital lock-and-key.

Features

- Unique Login Credentials
- Enterprise-Level Wireless
- Dedicated Conference and Meeting Rooms
- Staffed Front Desks
- Network Address Translators
- Firewalls
- Locked, Private Offices
- 24/7 Keycard Access



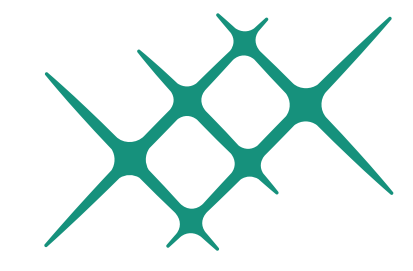

Health and Safety

We know where you work matters, and that getting back there is important. That's why our number one priority is reimagining our offices and the services we provide to help members feel safe, comfortable, and empowered at work.

Our health and safety protocols have been developed after consulting guidance from the CDC, OSHA, and a panel of expert advisors. Industrious also spearheads the Workplace Operators Readiness Council, a global group of the world's largest workplace operators seeking to establish new health and safety practices.

Frequent Cleaning & Sanitation

Offices are fully-furnished with oak desks and Herman Miller chairs.

Visual Communications

Signs have been placed throughout our locations to reinforce hygienic best practices such as hand washing.

Air Quality

HVAC systems have been adjusted to increase fresh airflow and reduce the risk of airborne transmissions.

Updated Layouts

To help members stay six feet apart throughout their day, furniture has been reconfigured in public spaces.

Reduced Capacity

Occupancy is limited in communal spaces, including conference rooms and cafés.

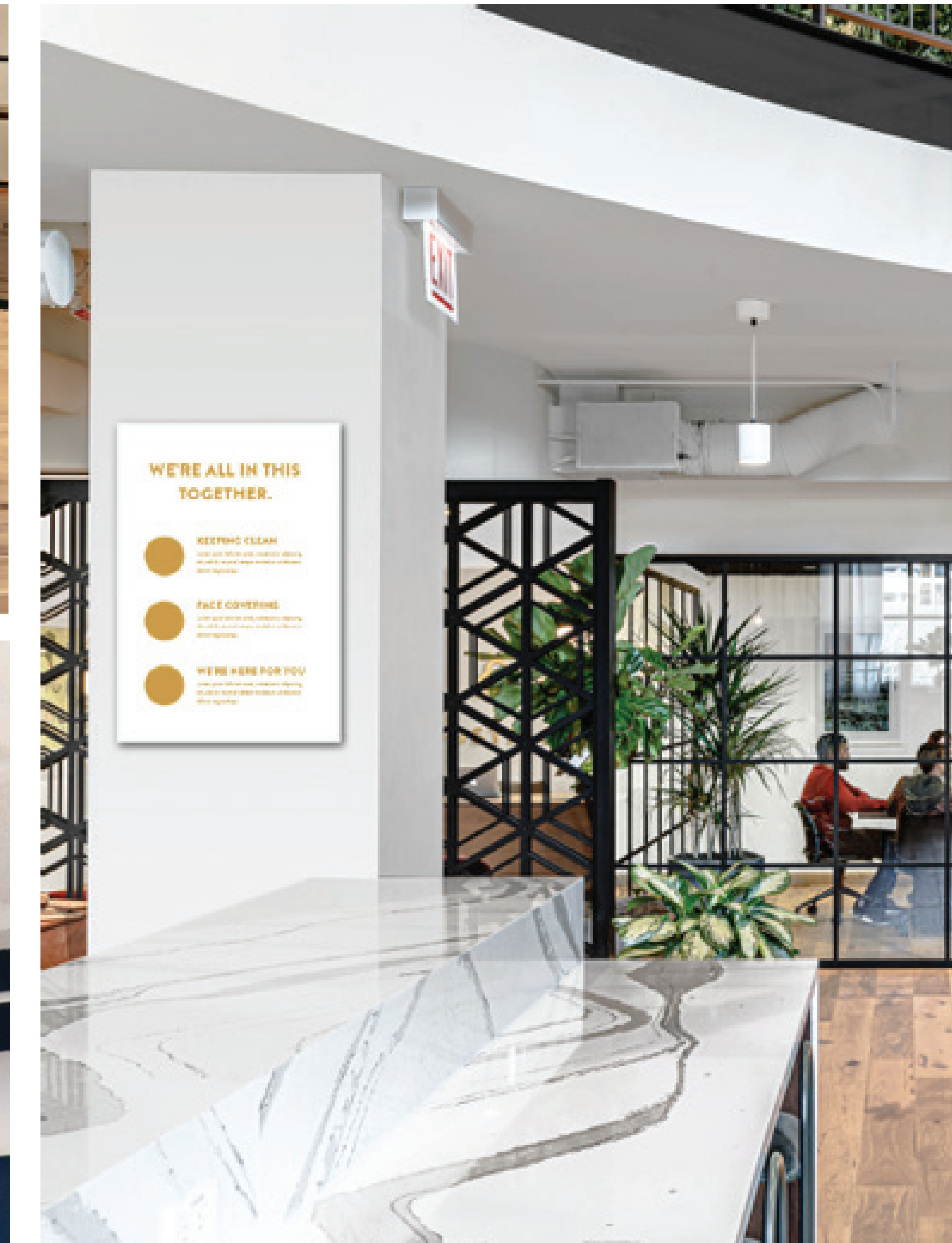
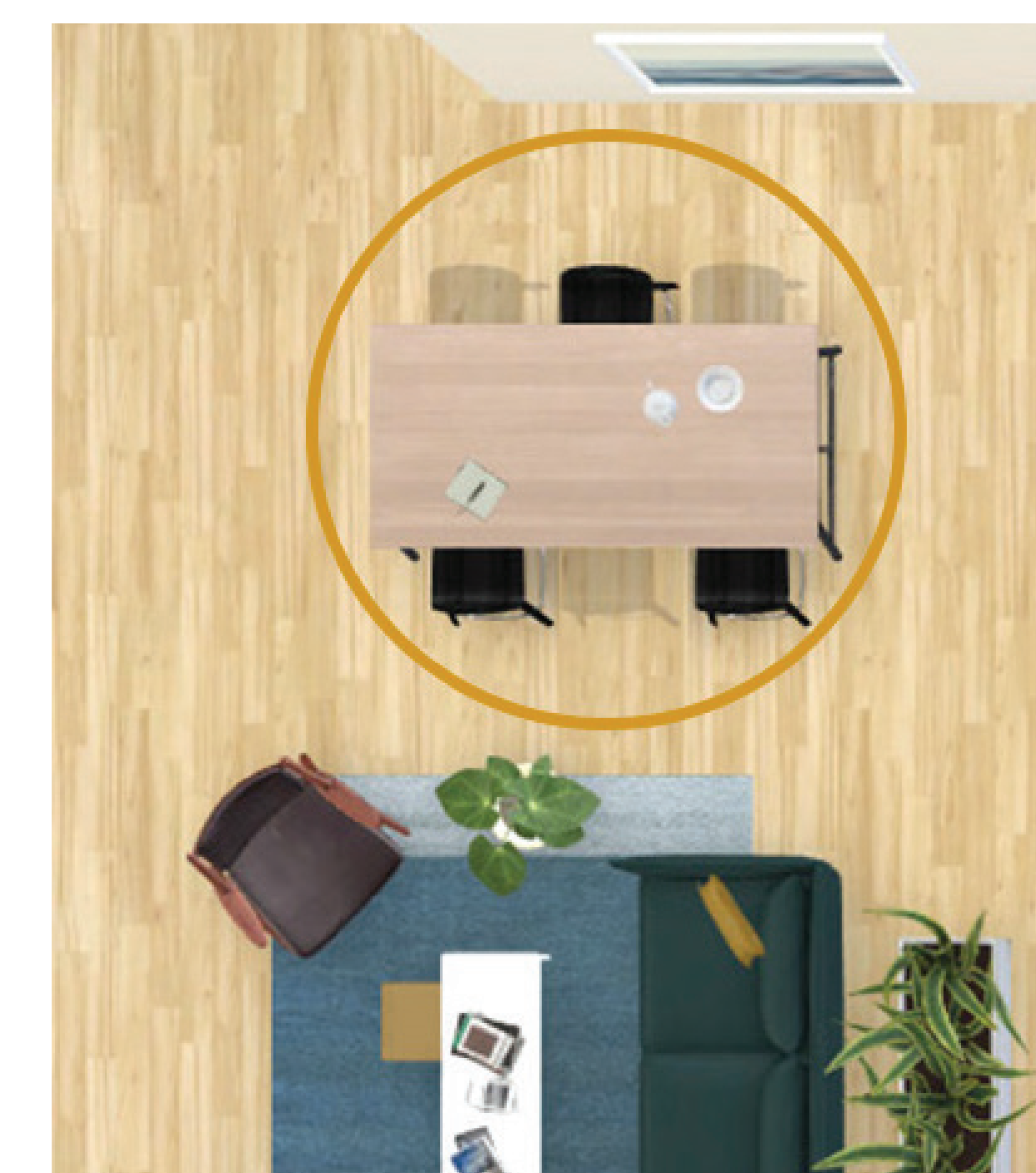
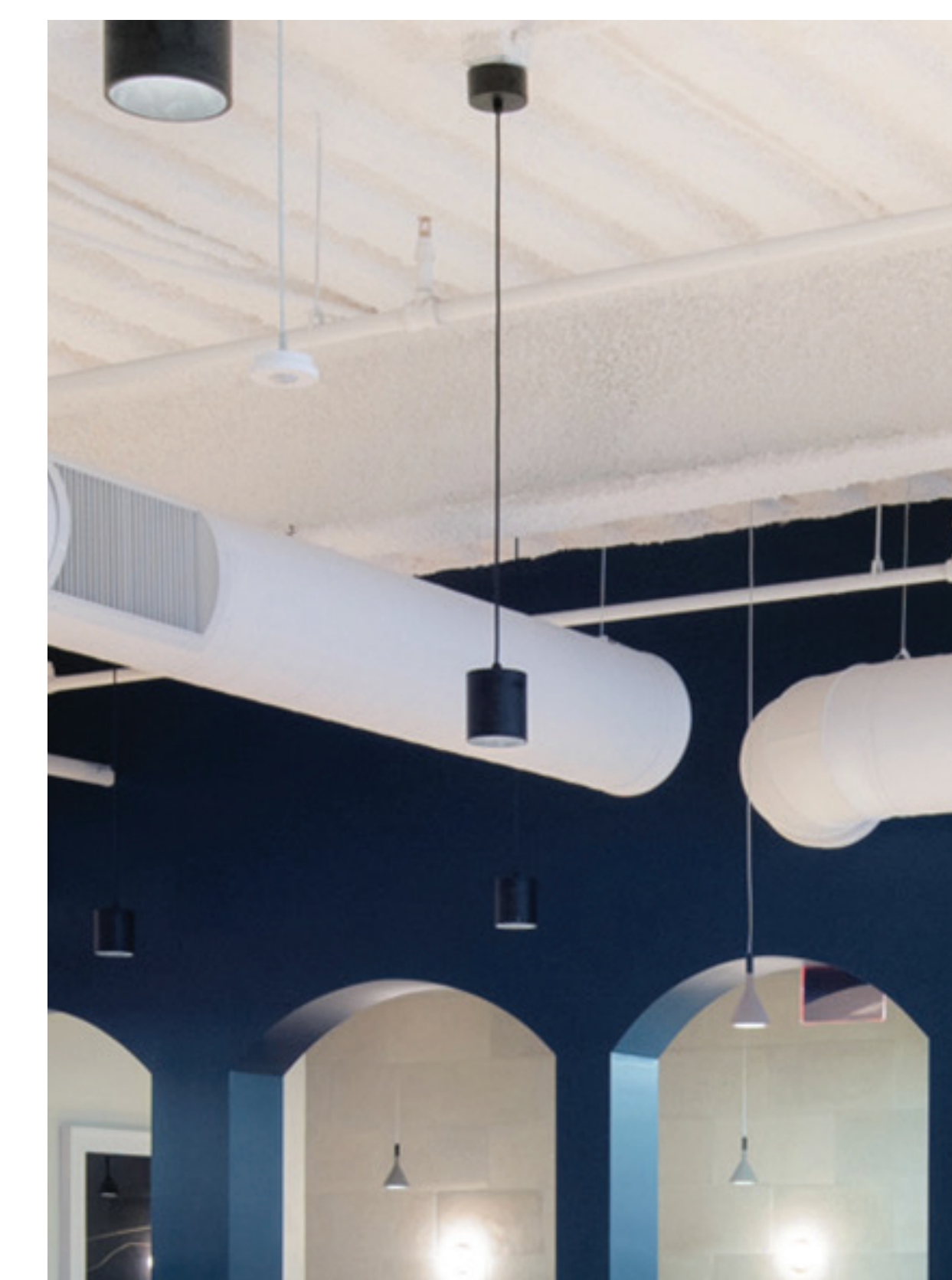

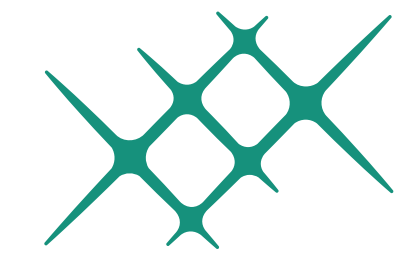

Membership With Global Access

Membership at WorkLife Office Suites unlocks access to Industrious' Global portfolio with 100+ locations in 50+ cities across the U.S., Singapore and beyond.

United States

- | | | |
|------------------|--------------------|-----------------------|
| Alexandria, VA | Kansas City, MO | |
| Aliso Viejo, CA | Los Angeles, CA | |
| Arlington, VA | Madison, WI | |
| Atlanta, GA | McLean, VA | |
| Austin, TX | Miami, FL | |
| Aventura, FL | Minneapolis, MN | |
| Bellevue, WA | Nashville, TN | |
| Bethesda, MD | New York, NY | Seattle, WA |
| Boston, MA | Newport Beach, CA | Short Hills, NJ |
| Boulder, CO | Orlando, FL | St. Petersburg, FL |
| Carmel, IN | Philadelphia, PA | Tampa, FL |
| Charlotte, NC | Pittsburgh, PA | Tysons, VA |
| Chicago, IL | Plano, TX | Walnut Creek, CA |
| Columbus, OH | Portland, OR | Washington, D.C. |
| Dallas, TX | Raleigh, NC | |
| Denver, CO | Salt Lake City, UT | International |
| Evanston, IL | San Diego, CA | Singapore |
| Houston, TX | San Francisco, CA | London, UK (Hana) |
| Indianapolis, IN | Scottsdale, AZ | Manchester, UK (Hana) |

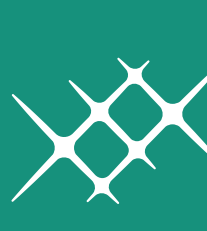
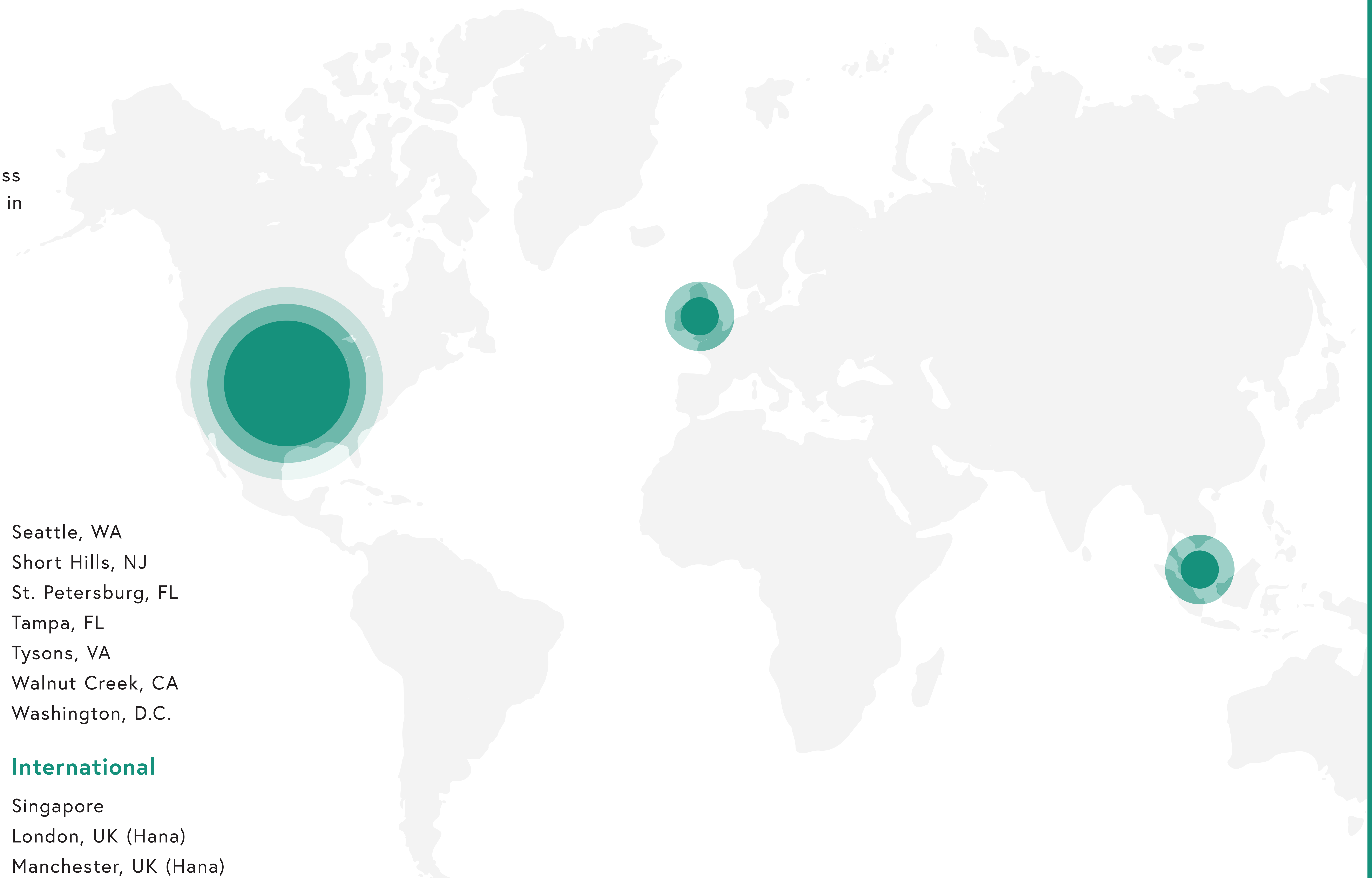

For more information, contact us at:

212-523-0480 | worklifebyvornado.com/office-suites | officesuites@worklifebyvornado.com

Stop by WorkLife Office Suites Sales Office

PENN 1 | Third Floor | New York, NY 10119

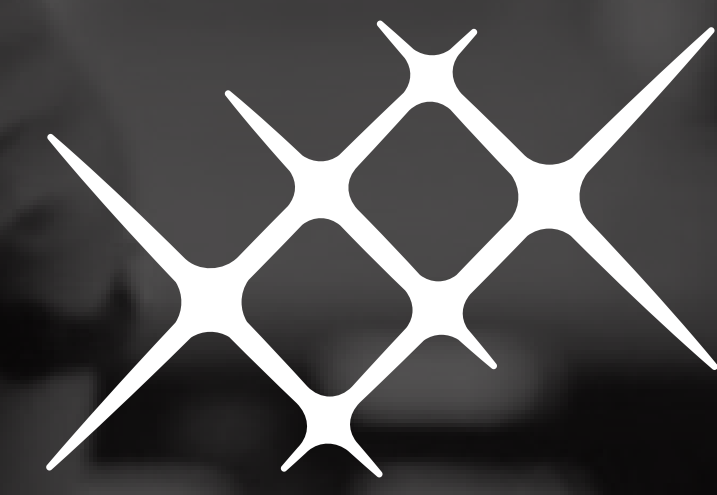

VORNADO
REALTY TRUST