

WorkLife MEETINGS

by **INDUSTRIOUS**

ROOM SCHEDULE

		HOURLY PRICE (\$)	MAX OCCUPANCY
A	Mountain Laurel Board Room	120	12
B	Red Maple Board Room	180	18
C	Honey Locust Board Room	180	18
D	Blue Beech Board Room	120	12
E	Pepperbush Hub	60	6
F	Benjamin Fig Board Room	120	12
G	Boxwood Hub	80	8
H	The Pitch Room	180	12
I	Magnolia Board Room	160	16
J	Redbud Board Room	120	12
K	The Studio	100	8

Included Amenities:

- Coffee, Tea & Snacks included all-day
- Seamless check-in process
- Built in phone booths for private calls
- Catering partner - DMK at the Landing & Office Hours
- In-room Light, Shade and AV Controls

Included Technology / AV Capabilities

- Wired audio/video connectivity
- High-speed wireless internet
- On-premise tech AV manager
- Polycom located in each boardroom



Contact Us Today: 917-764-MEET (6338) | WorkLifeMeetings@industriousoffice.com

Book your room directly through the Live.Work.Do. App | www.liveworkdo.com/splash

Hours of Operation: 8AM - 5PM

For events outside of normal business hours additional fees may apply





WorkLife MEETINGS

by **INDUSTRIOUS**

ASSEMBLY ROOM OVERVIEW

MAX OCCUPANCY

	ASSEMBLY 1	ASSEMBLY 2	GRAND ASSEMBLY
Sq Ft	803	740	1,543
Hourly Price (\$)	480	480	1,000

ROOM SET-UPS

Classroom	36	36	72
Team Style	24	24	60
Boardroom	TBD	TBD	TBD
Theater	50	50	100
U-Shape	24	24	34
Hollow Square	22	22	42

Included Tech / AV capabilities:

- Built-in & wireless microphones
- Built-in audience cameras
- Dual screen inputs (Quad inputs when combined)
- Wired audio/video connectivity
- Handheld & Lavalier microphones
- High speed wireless internet
- Podiums
- On-premise Tech AV Manager

Additional Capabilities (add-ons)

- Dedicated A/V technicians
- Additional Monitors & Screens
- Lighting upgrades
- Riser/Stage/Pipe and Drape

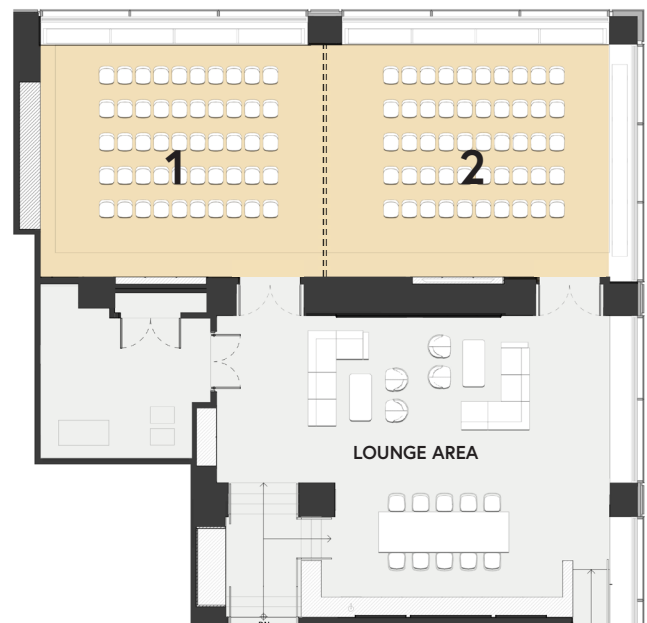

Included Amenities

- Full service reception and conference check-in counter
- Seamless check-in process
- Coffee, Tea & Snacks included all day
- Built in phone booths for private calls
- Catering partner - DMK at the Landing & Office Hours

Break Out Rooms and Lounge (add-ons)

- Large Pre-function Lounge

Contact Us Today: 917-764-MEET (6338) | WorkLifeMeetings@industriousoffice.com

Book your room directly through the Live.Work.Do. App | www.liveworkdo.com/splash

Hours of Operation: 8AM - 5PM

For events outside of normal business hours
additional fees may apply

