

WorkLife MEETINGS

by  JLL

THE MART
A VORNADO PROPERTY





Meeting Space to Keep Your Team Focused

A Space to Focus. WorkLife Meetings by JLL is a conferencing center like no other. An environment where all types of collaboration are not only possible, they're abundant. With 21,000 RSF, it's a place to make deadlines, deals, and everything in between. A modern business tool to keep you productive, efficient, successful. WorkLife. Solving For Your Day.

WorkLife Meetings features:

- Dedicated event coordination team
- On-demand meeting space
- Tenant lounge areas
- Executive catering
- State-of-the-art technology
- High-speed WiFi





Everything in One Place

WorkLife Meetings by JLL was developed to provide the space, services, and amenities needed to achieve unique collaboration goals. Located on the second floor of THE MART (Space #250) in Chicago, the intentionally designed layout includes a variety of spaces ranging from 300-person conference rooms to single-person meeting rooms.

Features include:

- Hospitality-forward check-in process
- Built-in phone booths for private calls
- Marshall's Landing Exclusive Catering Partner
- In-room light, shade, and AV controls
- Lounge seating for networking

Included Technology / AV Capabilities:

- Wired audio/video connectivity
- High-speed wireless internet
- On-premise AV manager
- Assisted listening systems in the Glass & Granite Room

Rooms are available in full-day and half-day increments and can be reserved by emailing worklifemeetings@themart.com or directly through the Live.Work.Do app at liveworkdo.com/splash.



Overview

ROOM SCHEDULE		SQ FT	MAX OCCUPANCY
A	Glass & Granite	4,461	300
B1	Glass (Half)	2,519	150
B2	Granite (Half)	1,943	150
C	Quartz	1,114	30
D	Limestone	767	24
E	Marble	444	14
F	Bronze	579	10
G	Zinc	380	8
H	Carbon	350*	6
I	Brass	258	6
J	Alloy	256	6
K	Cobalt	195	6
L	Copper	150	3
M	Stone	99	3
N	Steel	96	3
O	1-Person Room	75*	1

*approximate

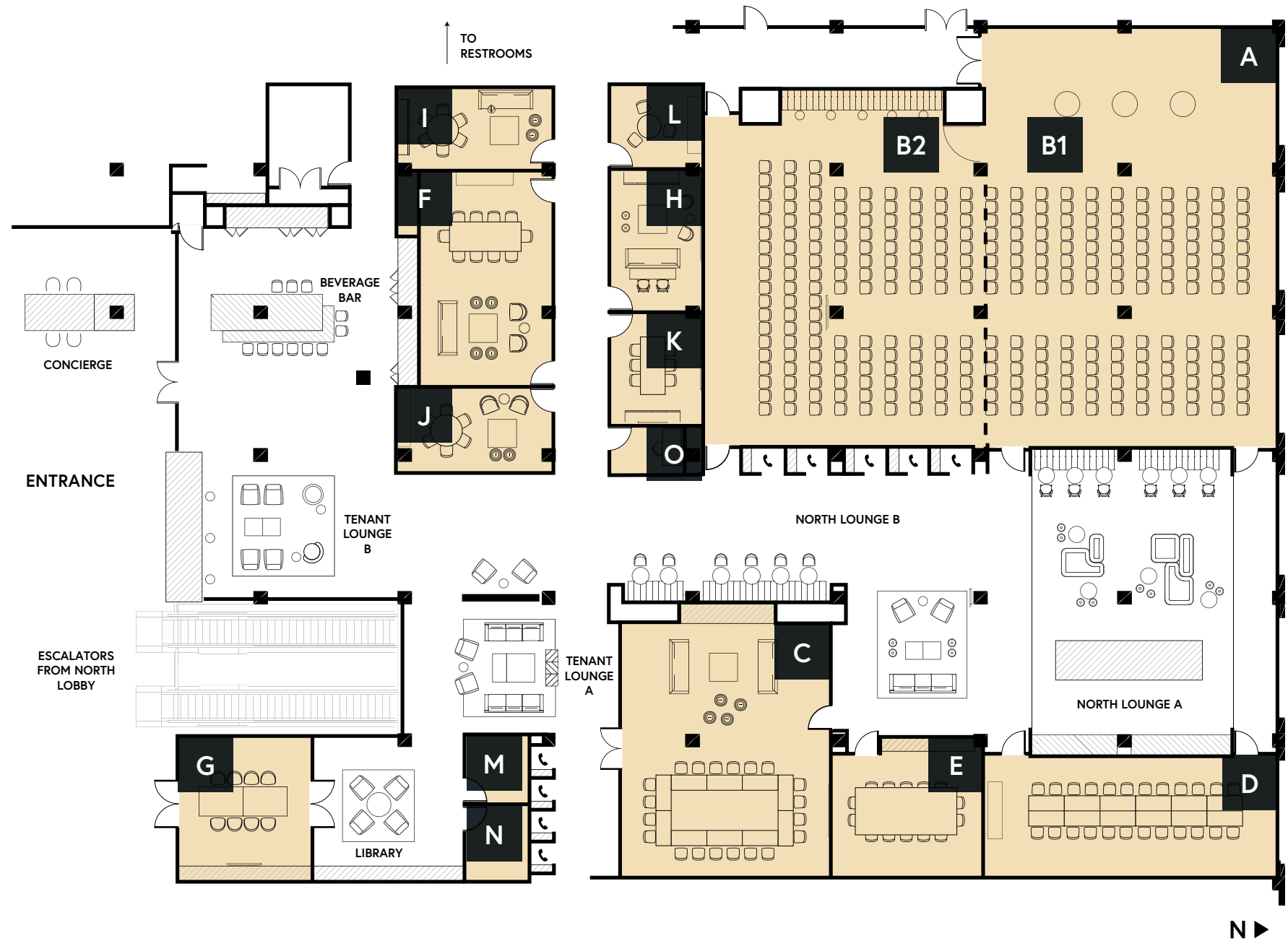



Beverage Bar



Tenant Lounge A



Tenant Lounge B







Glass & Granite Room

4,461 SQ FT

A

MAX OCCUPANCY	300
DAY RATE	\$2,400
HALF-DAY RATE	\$1,200

FEATURED AMENITIES

- (4) 163" 1.5MM pixel pitch front LED walls
- (2) wall-mounted monitors for presenters
- HDMI and USB connections
- (2) presenter cameras
- (4) audience cameras
- (10) wireless handheld microphones
- (10) wireless lavalier microphones
- (4) wireless earset microphones
- Multi-zone ceiling speakers for audio conferencing
- Wall-mounted touch panels for room controls
- Assisted listening systems

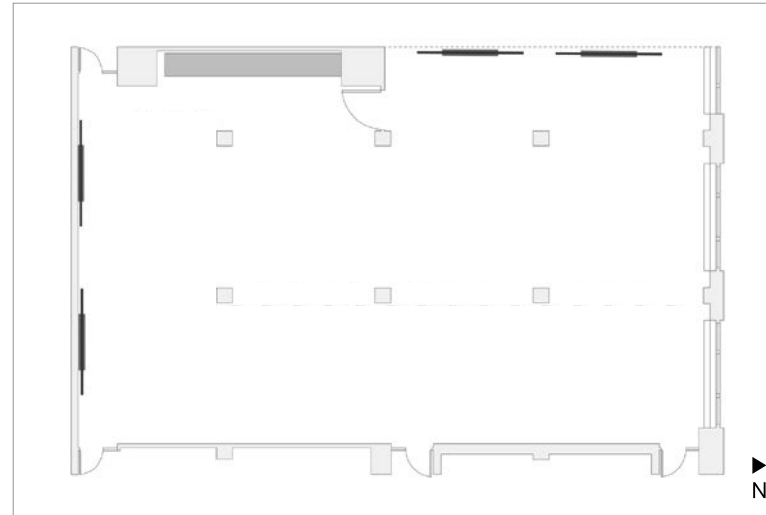

COCKTAIL HOUR

Standing Room Only • Max Occupancy: 300

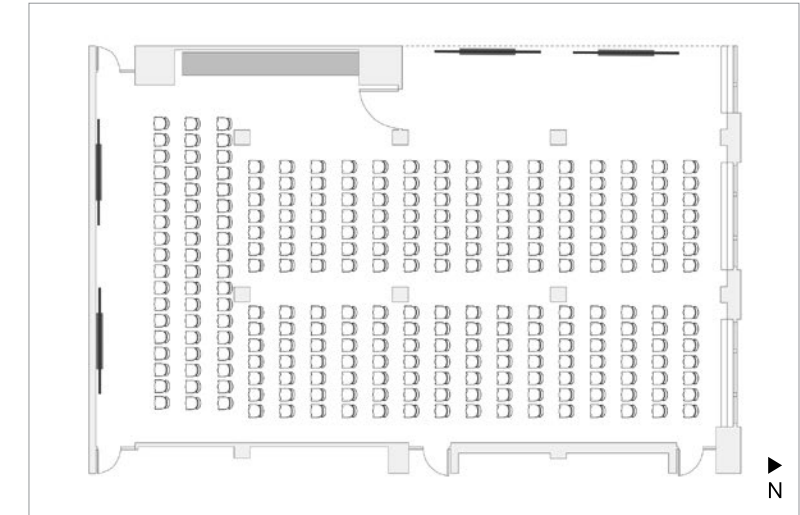

THEATER-STYLE

Chairs Only • Max Occupancy: 264

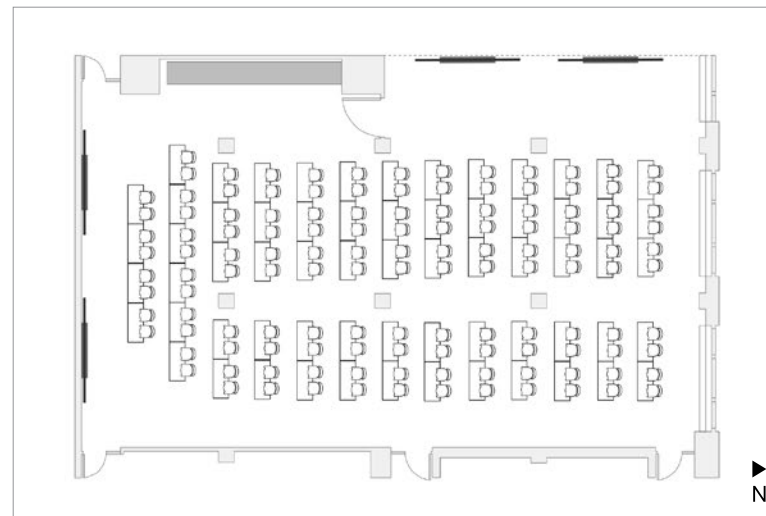

CLASSROOM-STYLE

Tables and Chairs in Rows • Max Occupancy: 130

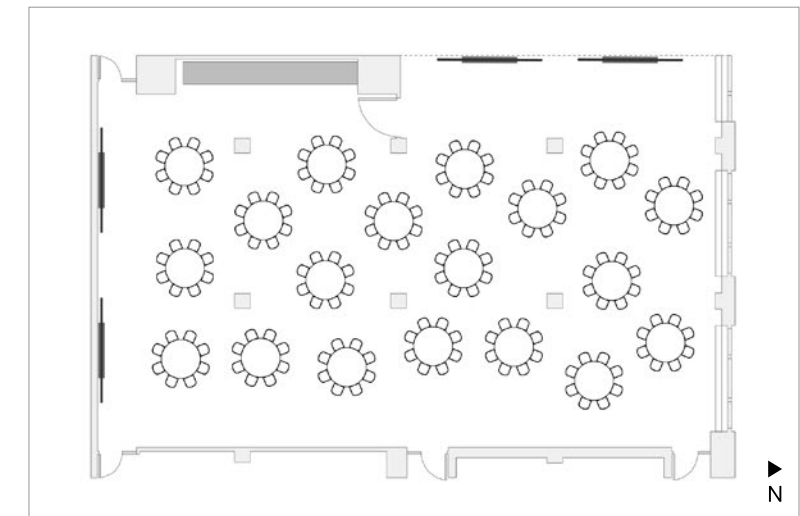

RECEPTION-STYLE

19 60" Tables, Each Seating 8 • Max Occupancy: 152

Glass Room

B1: 2,519 SQ FT

B1

Granite Room

B2: 1,943 SQ FT

B2

MAX OCCUPANCY (PER HALF)	150
DAY RATE	\$1,200
HALF-DAY RATE	\$600

FEATURED AMENITIES

- (2) 163" 1.5 pixel pitch front LED walls
- (1) wall-mounted monitors for presenters
- HDMI and USB connections
- (1) presenter cameras
- (2) audience cameras
- (5) wireless handheld microphones
- (5) wireless lavalier microphones
- (2) wireless earset microphones
- Multi-zone ceiling speakers for audio conferencing
- Wall-mounted touch panels for room controls
- Assisted listening systems

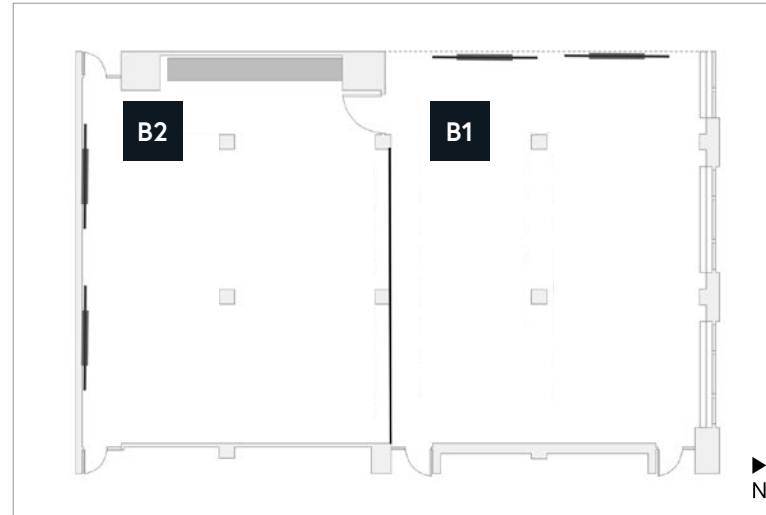

COCKTAIL HOUR

Standing Room Only • Max Occupancy: 150 (per half)

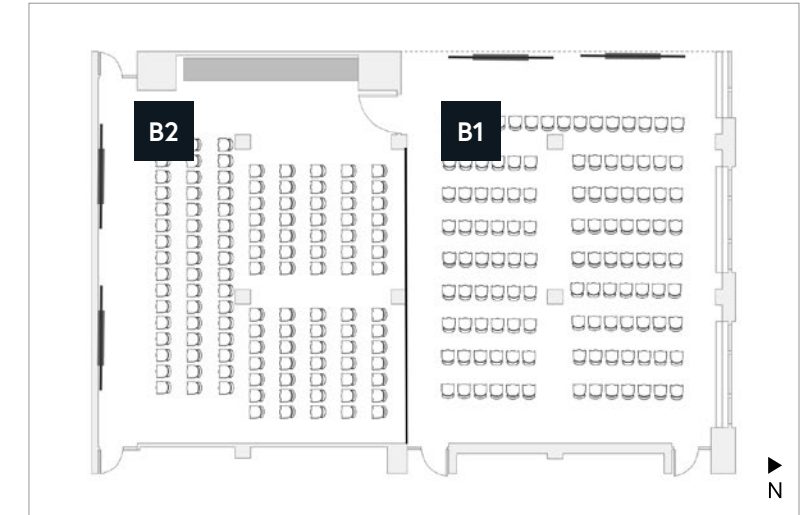

THEATER-STYLE

Chairs Only • Max Occupancy: 118 (per half)

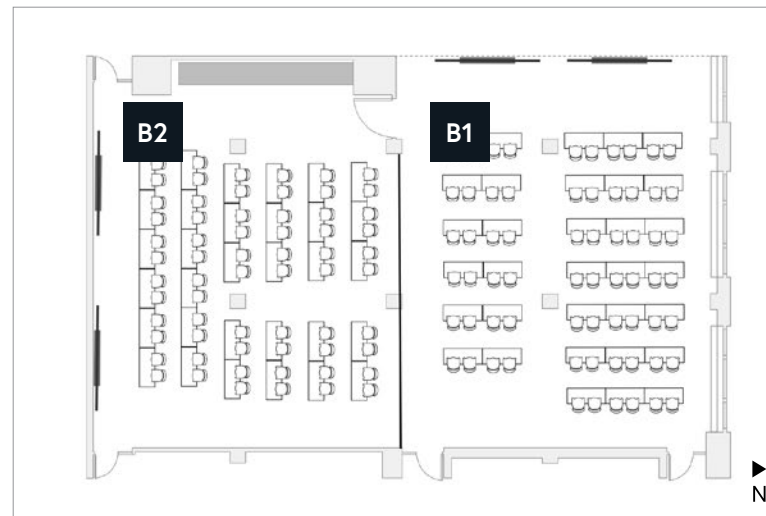

CLASSROOM-STYLE

Tables and Chairs in Rows • Max Occupancy: 66 (B1), 64 (B2)

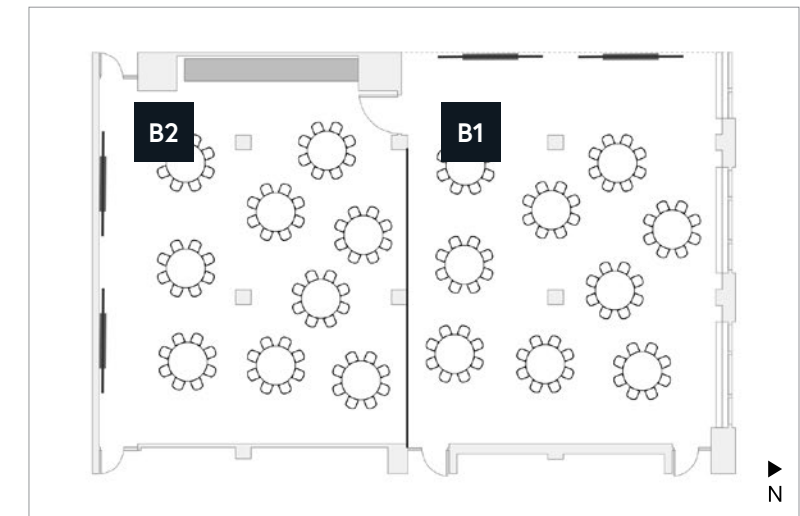

RECEPTION-STYLE

19 60" Tables, Each Seating 8 • Max Occupancy: 72 (per half)

Quartz Room

1,114 SQ FT

C

MAX OCCUPANCY	30
DAY RATE	\$700
HALF-DAY RATE	\$450

FEATURED AMENITIES

- (1) 98" wall-mounted flat panel display
- (1) 85" wall-mounted flat panel display
- HDMI and USB connections
- (1) fixed camera for video conferencing
- Ceiling microphones and speakers for audio conferencing

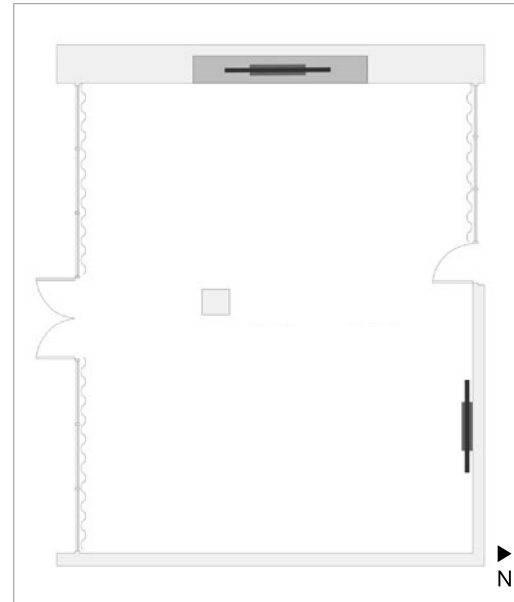

COCKTAIL HOUR

Standing Room Only
Max Occupancy: 30

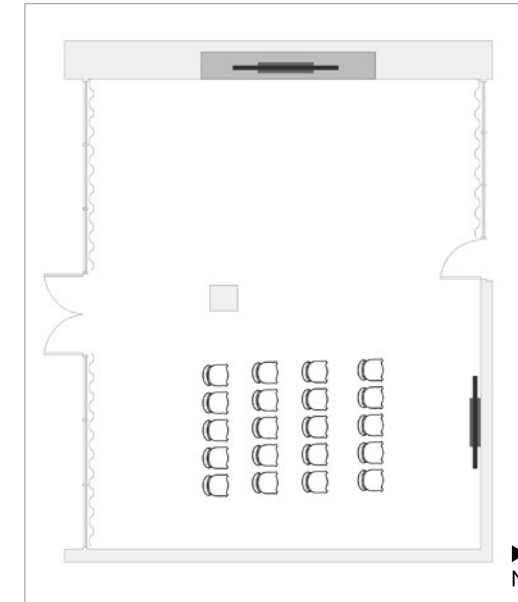

THEATER-STYLE

Chairs Only
Max Occupancy: 20

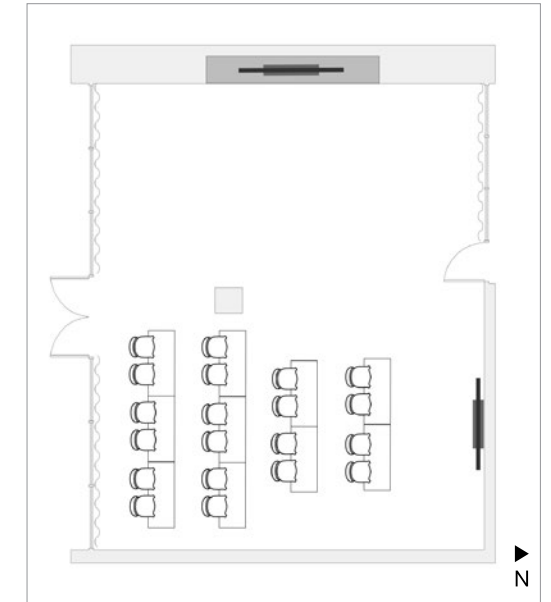

CLASSROOM-STYLE

Tables and Chairs in Rows
Max Occupancy: 20

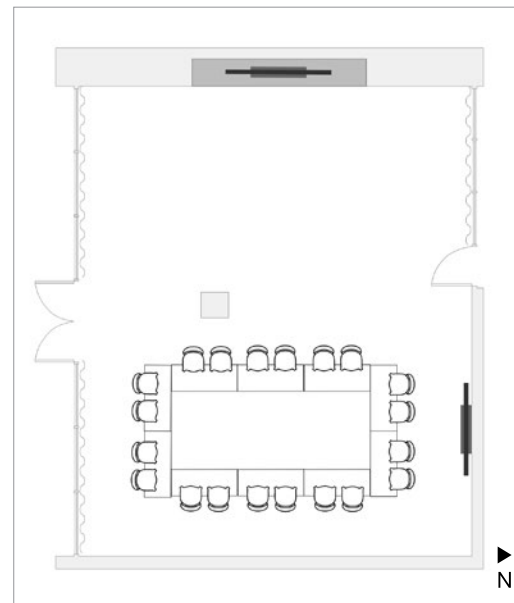

BOARDROOM-STYLE

Tables and Chairs in Hollow Square
Max Occupancy: 20

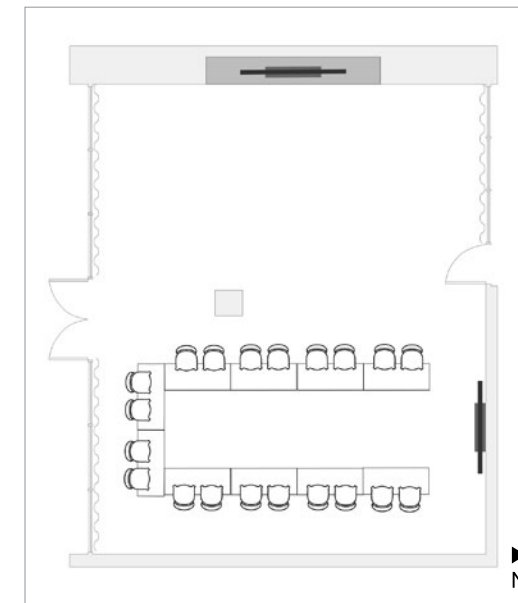

U SHAPE

Tables and Chairs
Max Occupancy: 20

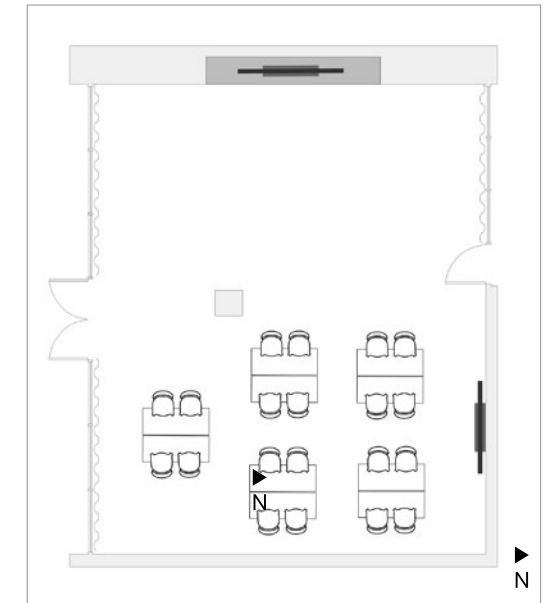

POD-STYLE

Chairs and Tables in Squares
Max Occupancy: 20

Limestone Room

767 SQ FT

D

MAX OCCUPANCY	24
DAY RATE	\$600
HALF-DAY RATE	\$300

FEATURED AMENITIES

- (1) 98" wall-mounted flat panel display
- (2) 55" wall-mounted supplemental monitors that mirror content
- HDMI and USB connections
- (1) fixed camera for video conferencing
- Ceiling microphones and speakers for audio conferencing

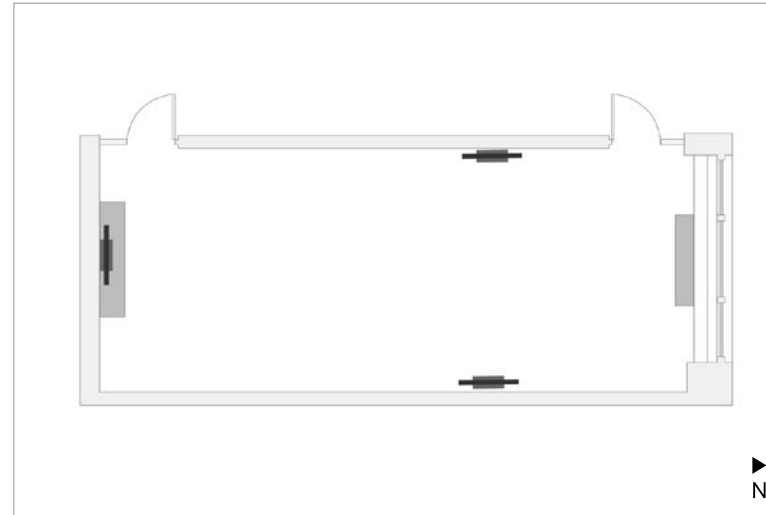

COCKTAIL HOUR

Standing Room Only • Max Occupancy: 24

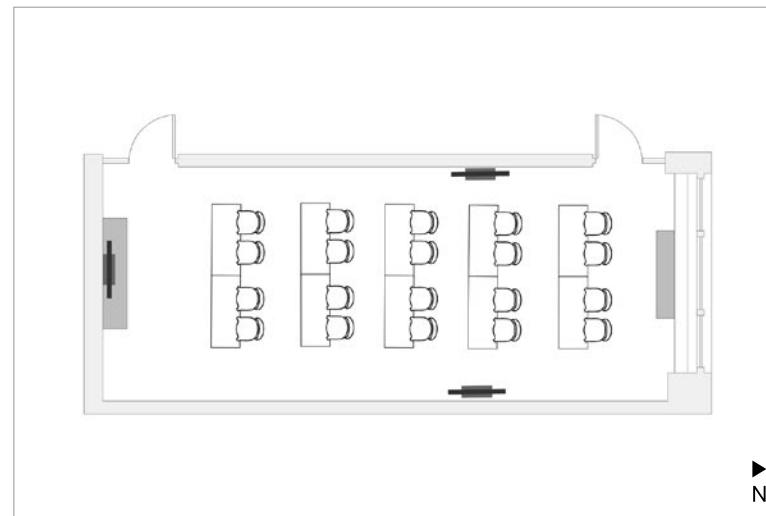

CLASSROOM-STYLE

Tables and Chairs in Rows • Max Occupancy: 20

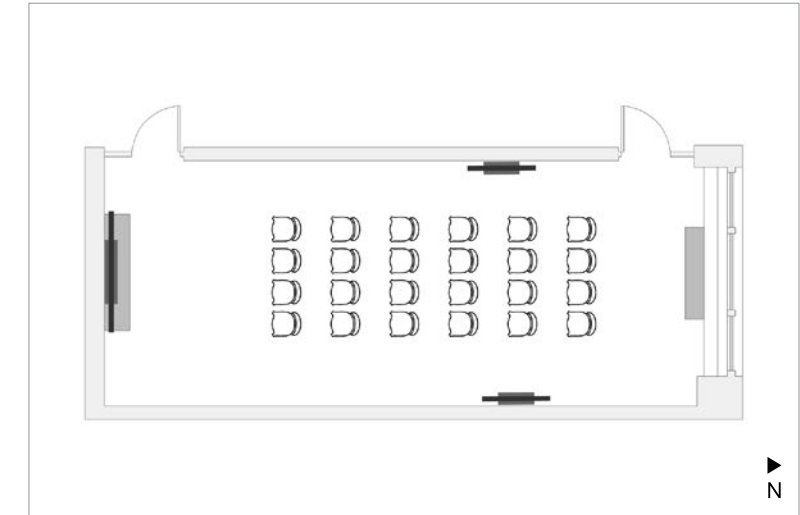

THEATER-STYLE

Chairs Only • Max Occupancy: 24

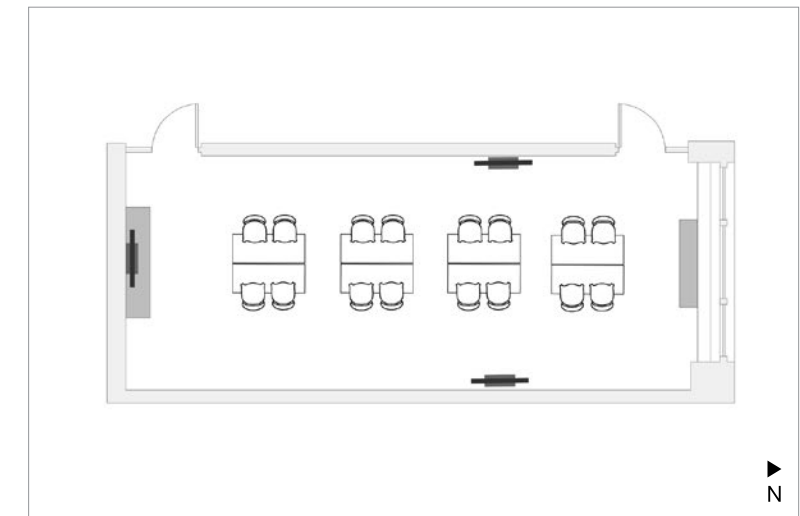

POD-STYLE

19 Tables, Each Seating 8 • Max Occupancy: 16

Marble Room

444 SQ FT

E

MAX OCCUPANCY	14
DAY RATE	\$400
HALF-DAY RATE	\$200

FEATURED AMENITIES

- (1) 85" wall-mounted flat panel display
- HDMI and USB connections
- (1) fixed camera for video conferencing
- Ceiling microphones and speakers for audio conferencing

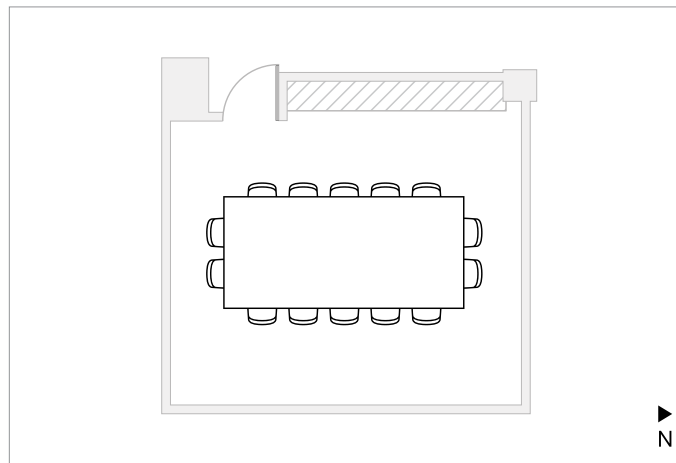

Bronze Room

579 SQ FT

F

MAX OCCUPANCY	10
DAY RATE	\$200
HALF-DAY RATE	\$100

FEATURED AMENITIES

- (1) 65" wall-mounted flat panel display
- HDMI and USB connections
- (1) fixed camera for video conferencing
- Ceiling microphones and speakers for audio conferencing

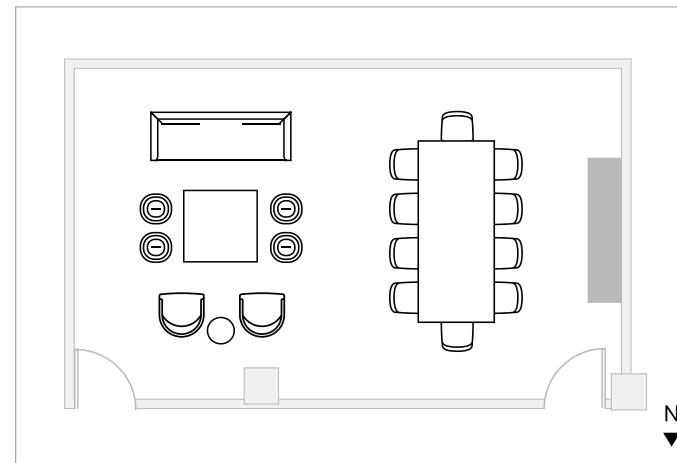



Zinc Room

380 SQ FT

G

MAX OCCUPANCY	8
DAY RATE	\$200
HALF-DAY RATE	\$100

FEATURED AMENITIES

- (1) 65" wall-mounted flat panel display
- HDMI and USB connections
- All-in-one microphone, camera and speaker for video conferencing

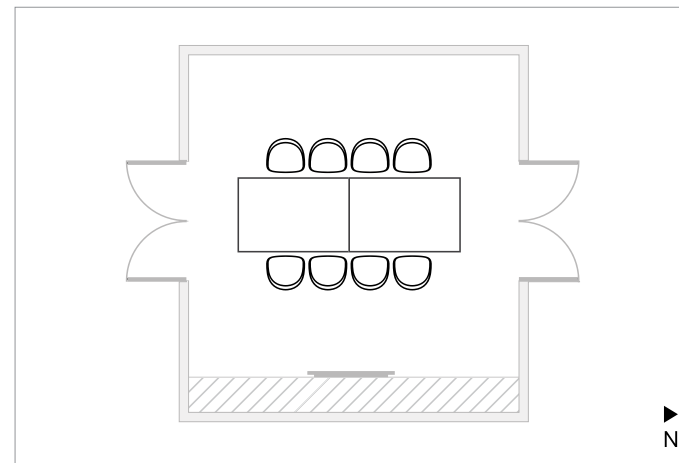

Carbon Room

350 SQ FT

H

MAX OCCUPANCY	6
DAY RATE	TBD
HALF-DAY RATE	TBD

FEATURED AMENITIES

- (1) 65" wall mounted flat panel display
- HDMI and USB connections
- (1) fixed camera for video conferencing
- Ceiling microphones and speakers for audio conferencing

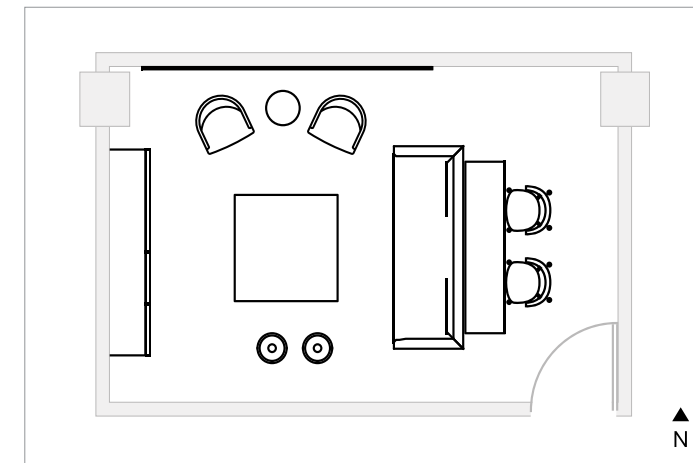

Brass Room

258 SQ FT



MAX OCCUPANCY	6
DAY RATE	\$200
HALF-DAY RATE	\$100

FEATURED AMENITIES

- (1) 65" wall-mounted flat panel display
- HDMI and USB connections
- (1) fixed camera for video conferencing
- Ceiling microphones and speakers for audio conferencing
- Lounge furniture

Alloy Room

256 SQ FT



MAX OCCUPANCY	6
DAY RATE	\$200
HALF-DAY RATE	\$100

FEATURED AMENITIES

- (1) 65" wall-mounted flat panel display
- HDMI and USB connections
- All-in-one microphone, camera and speaker for video conferencing
- Lounge furniture

Cobalt Room

195 SQ FT



MAX OCCUPANCY	6
DAY RATE	\$200
HALF-DAY RATE	\$100

FEATURED AMENITIES

- (1) 55" wall-mounted flat panel display
- HDMI and USB connections
- All-in-one microphone, camera and speaker for video conferencing

Copper Room

150 SQ FT



MAX OCCUPANCY	3
DAY RATE	Complimentary
HALF-DAY RATE	Complimentary

Available to reserve in 2-hour increments

FEATURED AMENITIES

- (1) 55" wall-mounted flat panel display
- HDMI and USB connections
- All-in-one microphone, camera and speaker for video conferencing

Stone Room

99 SQ FT



MAX OCCUPANCY	3
DAY RATE	Complimentary
HALF-DAY RATE	Complimentary

Available to reserve in 2-hour increments

Steel Room

96 SQ FT



MAX OCCUPANCY	3
DAY RATE	Complimentary
HALF-DAY RATE	Complimentary

Available to reserve in 2-hour increments

1-Person Room

75 SQ FT



MAX OCCUPANCY	1
DAY RATE	Complimentary
HALF-DAY RATE	Complimentary

Available to reserve in 2-hour increments



WorkLife MEETINGS

by  JLL



THE MART

A VORNADO PROPERTY

Contact Us Today
worklifemeetings@themart.com

Book your room directly through the Live.Work.Do. app
liveworkdo.com/splash

